

# SOGEp

BATIMENT

## Structural Design Office



Structure design

Roads and utilities Design

Construction works supervision

[www.sogepbatiment.com.tn](http://www.sogepbatiment.com.tn)

## 1 PRESENTATION

SOGEP is a design office specializing in structural design, Roads and utilities design and Construction works supervision of building projects.

## 2 OUR SERVICES



### STRUCTURES DESIGN

Realizes the plans of structures, Calculation notes and Modeling of buildings in coordination with the project management team. SOGEP treated the buildings in reinforced concrete and metal frame and intervenes at all stages of the projects : Preliminary Design, detailed Design and Tender Documentation.



### ROADS AND UTILITIES

- Roads: Drawing plans, Long profiles, Cross profiles,
- Sizing of the pavement structure.
- Waste : Design of sanitation connections.
- Rainy waters: Sizing of the rainy water's connections.



### CONSTRUCTION WORKS SUPERVISION

- Contractor appointment assistance
- Requisites for the works commencement
- Controls in the Suppliers workshops
- Control of the application of the contractual terms
- Control of the works quality and Budget control

## 3 DOMAINES D'ACTIVITES

**SOGEP** intervenes in several fields of activity:



RESIDENTIAL PROJECTS



HEADQUARTERS



INDUSTRIAL PROJECTS



PUBLIC ESTABLISHMENT



HYDRAULIC WORKS



A VILLA

## 4 HUMAN RESOURCES

SSOGEP has the human resources and the material means necessary for the good conduct of your projects. The SOGEP team is made up of engineers and civil engineering technicians who participated in structural studies of various complex projects.

## 5 SOME PROJECTS IN TUNISIA

### HABITATION

#### R+2 Menzah V

**Client :** Private

**Mission :** Structure design

**Area :** 1900 m<sup>2</sup>

**Description :** Construction of building composed of an underground, a ground floor and 2 floors covering a surface of 21 900 m<sup>2</sup> in Tunis.

**Archite :** Fakher Turki and Partners



#### Polygone

**Client :** Polygone

**Mission :** Structure design

**Area :** 1800m<sup>2</sup>

**Description :** Construction of building composed of an underground, a ground floor and 2 floors.

**Architect :** SIGMA Architecture (Sami Louizi)



#### R+2 Gammarth

**Client :** M.Lakhoua

**Mission :** Structure design

**Area:** 1400 m<sup>2</sup>

**Description :** Construction of building composed of an underground, a ground floor and 2 floors.

**Architect :** Mr.Adly BEN SOLTANE



#### R+2 Elagba

**Client :** Private

**Mission :** Structure design

**Area :** 1200m<sup>2</sup>

**Description :** Construction of building composed of an underground, a ground floor and 3 floors.

**Architect :** SIGMA Architecture (Sami Louizi)

## 5 SOME PROJECTS IN TUNISIA

### HEADQUARTERS



#### EXTENSION HOTEL MERIDIANA

**Client :** SPT IMMOBILIERE

**Mission :** Structure design

**Area :** 7 500 m<sup>2</sup>

**Description :** Construction of 150 rooms of the hotel «Meridiana» in Djerba. This building is composed of 02 floors.

**Architect :** Mr.Nezih Kchih



#### CLUB OF LAWYERS

**Client :** ORDRE OF LAWYERS

**Mission :** Structure design

**Area :** 1 500 m<sup>2</sup>

**Description :** Construction :

- Lounge restaurant : composed of a ground floor and one floor covering a surface of 700 m<sup>2</sup>;
- Snack Restaurant composed of a ground floor acovring a surface 400 m<sup>2</sup>;
- Construction of a pool a surface of 400 m<sup>2</sup>

**Architect :** Mr Haythem BEN ROMDHANE

#### R+4 Lafayette

**Client :** M.CHaabène

**Mission :** Structure design

**Area :** 3 400 m<sup>2</sup>

**Description :** Construction of a building composed of an underground, ground floor and 4 floors covering a surface of 3 400 m<sup>2</sup>

**Architect:** Mr.Adel MZALI



#### HEADQUARTERS SOTELCO

**Client :** SOTELCO

**Mission :** Structure design

**Area :** 3 000 m<sup>2</sup>

**Description :** Construction of a building composed of a ground floor and 3 floors covering a surface of 2600 m<sup>2</sup>

**Architect :** Mr.Wassim Talbi

## 5 SOME PROJECTS IN TUNISIA

### INDUSTRIAL

#### FACTORY CONFORTLUX

**Client :** CONFORTLUX

**Mission :** STRUCTURE DESIGN

**Area :** 2 100 m<sup>2</sup>

**Description :**

Structural studies of a 1300 m<sup>2</sup> metal frame manufacturing unit and an R + 2 administrative block covering an area of 800 m<sup>2</sup>.

**Architect :** M.Rami Masmoudi



#### FACTORY Mghira

**Client :** M.CHERIF

**Mission :** Etudes de Structures

**Area :** 1 000 m<sup>2</sup>.

**Description :** construction of building composed of ground floor and one floor covering a surface 1 000 m<sup>2</sup>.

**Architect :** SIGMA Architecture (Sami Louizi)



### ROADS AND UTILITIES

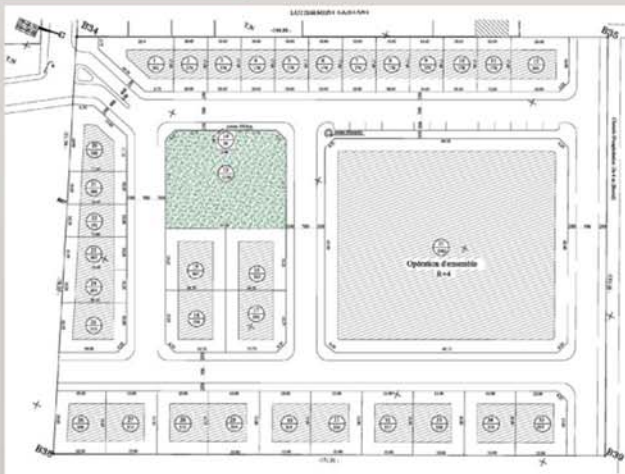

#### Allotment Mourouj

**Client :** TUNIBAT

**Mission :** Design

**Area :** 2.5 HA

**Description :** Roads and utilities design of allotment 2,5 Ha in Mourouj 6.

**Architect :** Mr.Cherif Daoued

#### Allotment Ain Zaghouan

**Client :** Private

**Mission :** Design

**Area :** 2 Ha

**Description :** Roads and utilities design of allotment in Ain zahouane covering a surface of 20000 m<sup>2</sup>

**Architect :** Mr.Mohamed BOUKATTAYA

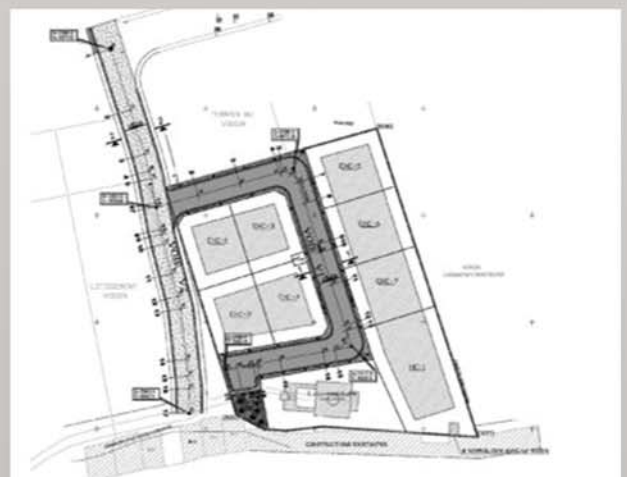

## 6 SOME PROJETS IN FRANCE

Thanks to our skills, our seriousness, our respect of deadlines and our commitments, during the last few years, we have been able to develop a large network of europe study office partners. As a subcontractor, we realized the structural design of many projects in europe.

SOGEF intervenes in all phases of the project, such as: Preliminary Design, detailed Design and Tender Documentation.

We have also made available to our partners resources according to their needs (engineers, technicians).

SOGEF also carried out specific tasks on behalf of our partners:

- Sizing of structural elements (beams, stringers, slabs)
- Drawing of the formwork and reinforcement plans.



### R+8 Colombes

**Client :** BET

**Mission :** Structure design

**Area :** 20 000 m<sup>2</sup>

**Description :** Construction of a residential building composed of an underground, a ground floor and 8 floors covering a surface of 20 000 m<sup>2</sup> in Colombes- Paris-France.

**Partner :** ALPHA Engineering



### R+8 Paris

**Client :** BET

**Mission :** Technical Assistance

**Area :** 12 000 m<sup>2</sup>

**Description :** Rehabilitation of a building composed of an underground, a ground floor and 8 floors covering a surface of 12000 m<sup>2</sup> in Paris 12-France.

**Partner :** ALPHA Engineering



### Aquarrelle

**Client :** BET

**Mission :** Structure design

**Area :** 3 000 m<sup>2</sup>

**Description :** Construction of a building composed of 28 apartments in Lille-France covering a surface of 3000 m<sup>2</sup>.

## 7 PROJECTS IN AFRICA

During the last years, SOGEP has put in place a commercial strategy to develop its market in Africa. Actually, SOGEP is conducting structural design of several prestigious projects in Mali, in Ivory Coast and Togo.

### R+5 in Togo

**Client :** Private

**Mission :** Structure Design

**Area :** 3500 m<sup>2</sup>

**Description :** Construction of a residential building composed of an underground, a ground floor and 5 floors covering a surface of 3500 m<sup>2</sup> In Togo.

**Architect :** Fakher Turki and Partners

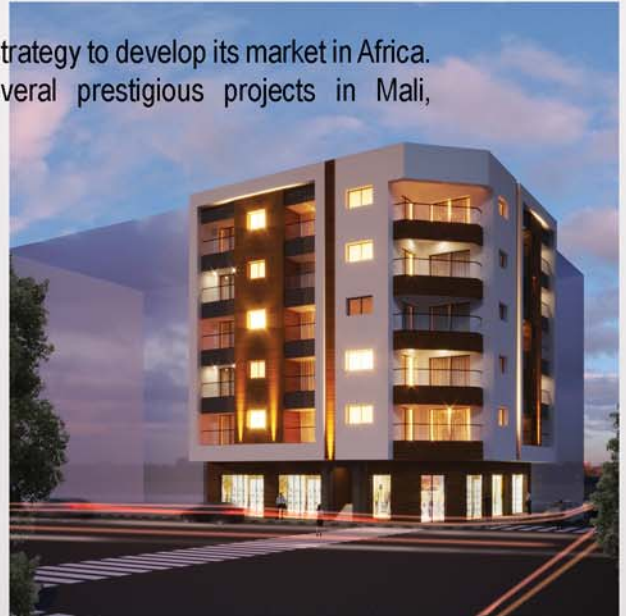

### ALLOTMENT CIRA

**Client :** CIRA

**Mission :** Roads and utilities Design

**Area :** 90 000m<sup>2</sup>

**Description :** This is an Allotement in Bamako-Mali composed of 92 villas, restaurant, green space...

**Architect :** Fakher Turki and Partners



### Villas/Mali

**Client :** CIRA

**Mission :** EStructures design

**Area :** 1 000 m<sup>2</sup>

**Description :** Construction of 92 villas in the allotment of CIRA in Bamako -Mali

**Architecte :** Fakher Turki and Partners

### Restaurant and SPA/ Mali

**Client :** CIRA

**Mission :** Structure design

**Area :** 3000 m<sup>2</sup>

**Description :** Construction of a restaurant, a SPA and a sports hall in the allotement of CIRA in Bamako -Mali.

**Architect :** Fakher Turki and Partners





SOGEP is present in several countries worldwide :Tunisia, France, Mali, Togo, Ivory Coast, and Senegal.

**SOGEP**  
BATIMENT

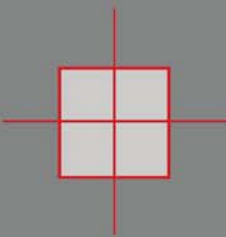

contact@sogepbatiment.com.tn  
sogepbatiment@gmail.com



(+216) 71 701 464 /  
(+216) 92 543 017



29 Avenue of Independence,  
Residence Mariam, Ariana - 2080



www.sogepbatiment.com.tn